

THE
belmont
HOTEL

BUSINESS AT
THE BELMONT



Conferences & Banqueting at The Belmont!

Conferences and business meetings run smoothly at The Belmont and the hotel is renowned for a warm and friendly welcome. We have 10 conference rooms incorporating versatile spaces for up to 200 delegates and whether your numbers are large or small there will be a room to suit your purposes at The Belmont Hotel.

Ideally situated for Leicester's business quarter, there's free car parking for delegates, but the hotel is equally accessible on foot or by public transport with Leicester Railway Station just around the corner. All of our meeting rooms have natural daylight and the majority also offer air conditioning to keep delegates alert throughout the event.

All our meeting rooms come with pads, pencils, water, stationery box and sweets as

standard. We have a dedicated conference host who will meet and greet you on the day of your meeting and will be on hand for anything you may require throughout the day. If you require any equipment for your meetings we can arrange this either in-house or we can hire it for you. These maybe subject to a hire charge, please enquire as necessary. You are also welcome to bring your own equipment along if preferred. All our rooms (with the exception of the Townsend and the Oval) are easily accessible on the ground floor and the hotel offers accessible accommodation and has a hearing induction loop installed.

Our events team is always happy to tailor packages to your specific requirements. We offer wi-fi internet access throughout the hotel and delegates whether staying over or just here for a day meeting receive

free internet access for two hours or can upgrade that for 24 hour access. There is also a PC in the reception area for guests and we do offer secretarial services should you require them.

The Belmont comes into its own for private dinners and functions. The Rose and Rowan rooms which link together are ideal for large scale banqueting and there are a number of rooms for directors' dinners, boardroom lunches and awards dinners.

The Belmont Hotel offers great banqueting options from formal dinners to large scale buffets, champagne breakfasts or drinks receptions. We can offer cocktails and canapes out on the terrace, followed by a sumptuous dinner from our extensive menu. Our events team can advise which options would be perfect to fulfill your requirements.

THE
belmont
HOTEL













Flexibility is key for event managers so our menus have been put together accordingly. We can offer breakfast breaks, a no-time-to-stop lunch, a full finger buffet or two course restaurant meal so that it can fit in with your own conferencing schedule. Biscuits and cakes served during tea and coffee breaks are all homemade, providing that extra detail. Whether you're meeting

for an informal coffee and a chat in Jamie's Bar or you need to get your team together more formally, we will be able to help. During the summer months we can provide a barbecue lunch and strawberries and cream out on the terrace. If you let us know of any special dietary requirements, we can ensure that this is all catered for during your event.

The Belmont is striving to improve its environmental credentials and operates an environmental policy: please contact us for a copy or have a look at our environmental policy page on the website www.belmonthotel.co.uk

ROOM DIMENSIONS

Room	Dimensions/ Capacity	Theatre 	Cabaret 	Class Room 	Board Room 	U Shaped 	Banquet 	Dinner & Dance 	Cocktail/ Reception 
Rose Suite (1+2+Rowan)	25.6 x 7.92m 82' x 26'	-	-	-	-	-	160	150	200
Rose (Rose (1+2))	20.7 x 7.92m 66'6 x 26'	175	100	75	60	55	120	100	175
Rose 1	11.89 x 7.72m 27'6 x 26'	50	N/A	30	20	20	30	N/A	50
Rose 2	8.38 x 7.92 39' X 25'4	75	45	40	35	30	40	N/A	100
Rowan	15.75 x 4.88m 51'8 X 16'	75	N/A	40	30	20	40	N/A	75
May	9.45 x 7.92m 16' x 17'	65	35	30	30	25	50	40	75
Crawford	4.90 x 5.18m 16' X 17'	25	N/A	12	14	12	20	N/A	25
Study/Oval	6.15 x 4.72m 20'2 X 15'6	N/A	N/A	12	15	14	N/A	N/A	N/A
Townsend/ Halliday	6.15 x 4.72m 20'2 X 15'6	N/A	N/A	12	15	14	N/A	N/A	N/A

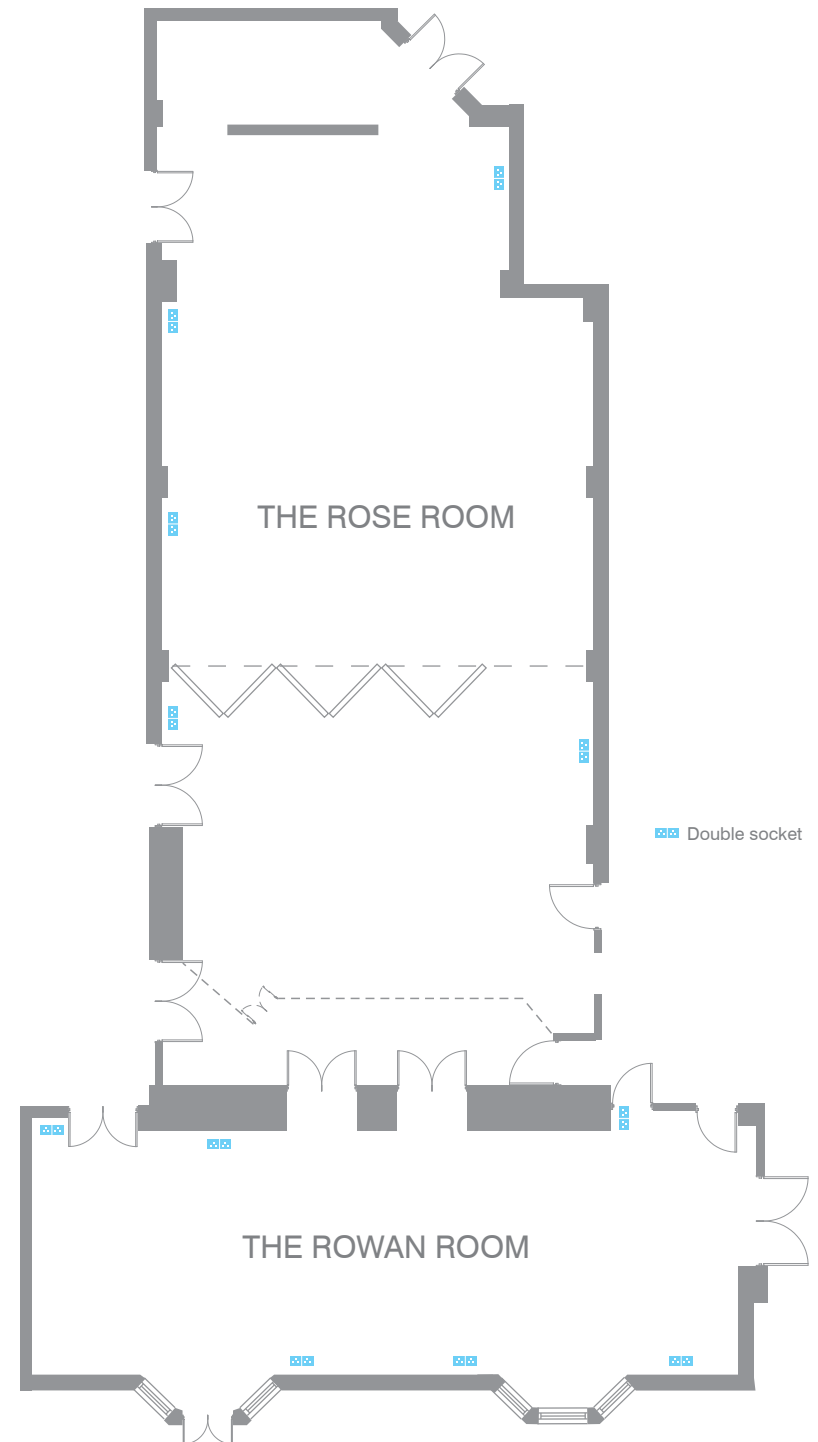
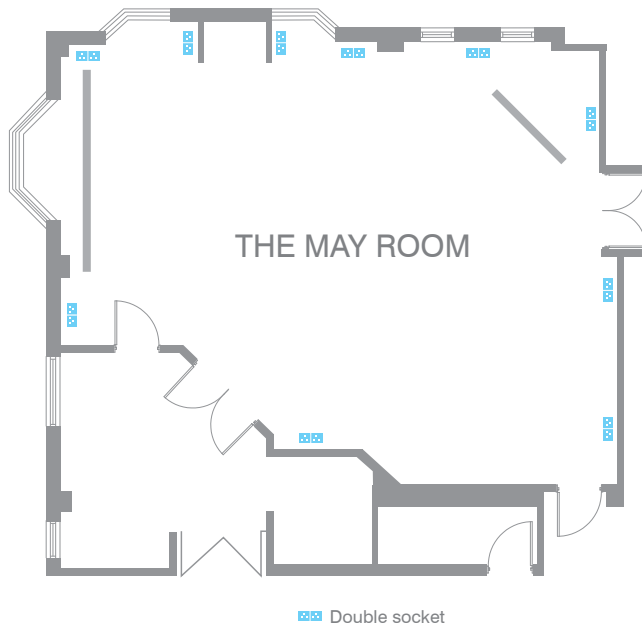

FLOOR PLAN

The Rose is our largest room and seats 175 in a theatre style layout. It can also interlink onto our Rowan Room and in total this can seat 165 for a banquet. Ideal for larger conferences, together they offer space where you could gather delegates for coffee and then move into the main presentation area.

The Rose Room has a fitted PA system and plenty of electrical points and also splits into two separate areas (Rose 1 & 2) for individual meetings. Rose 2 offers natural daylight. The Rowan Room, that can link to the Rose, is a lovely space on its own for a smaller meeting or private dinner. It seats up to 75 in a theatre layout.

The May Room has its own individual foyer where light refreshments can be served. It has easy access from the front doors of the hotel and also offers its own private bar for smaller functions. It has two built in screens and plenty of natural daylight.

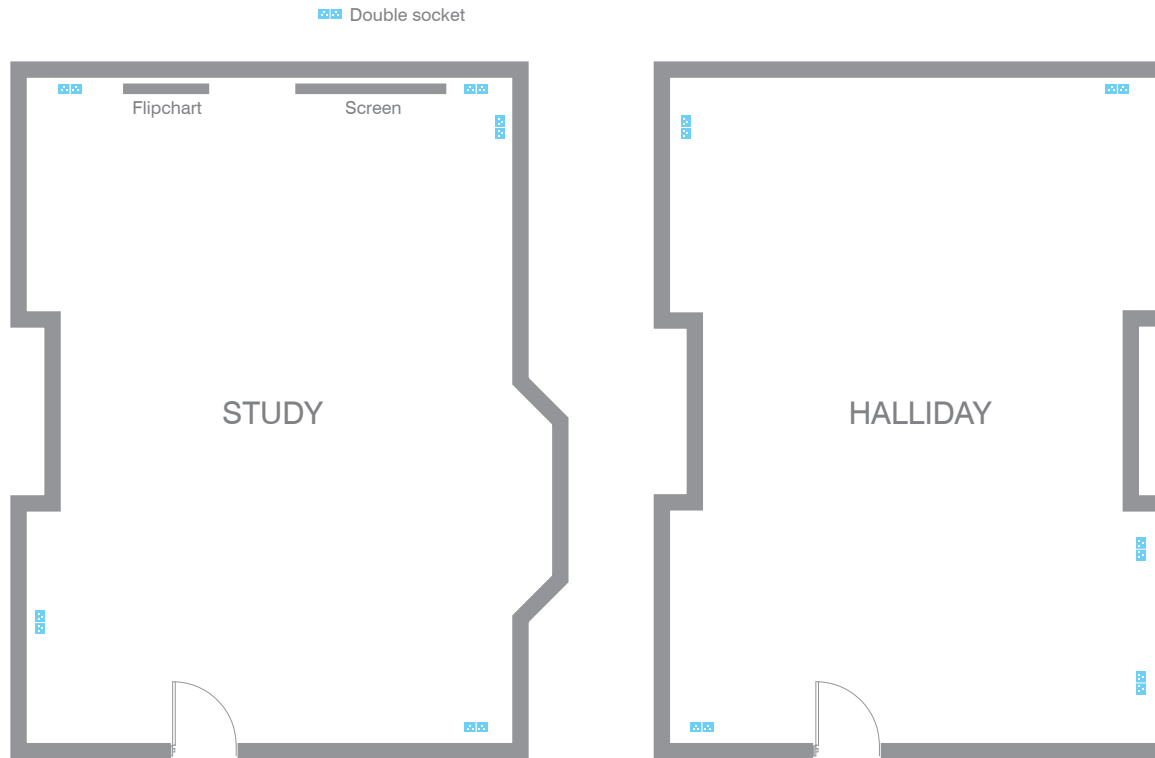

In our business centre, there are four meeting rooms, two on the ground floor and two on the first floor, which are often used together as conference areas with breakout rooms. Each of these rooms accommodates up to 20

people in a theatre layout. These can be set out as required, but on each floor one of the rooms includes sofas, a small table and coffee machine. The Study and the Halliday (plans on this page) are in the self-contained business

centre and are mirrored in size and shape by the Townsend and the Oval on the first floor.



THE
belmont
HOTEL

Directions

By rail, Leicester Station direct to London St Pancras - five minutes walk.

By road from the South (approx 6 miles) - M1 Junction 21, A563 Soar Valley Way, Attlee Way, Asquith Way, Palmerston Way. Turn left at A6 towards Leicester on London Road, left into De Montfort Street.

By road from the North - M1, Junction 22, A50 Leicester, A594 Ring Road following signs to railway station to A6 London Road, right into De Montfort Street.

By air, East Midlands Airport - approximately 30 minutes drive.

The Belmont has facilities for people with disabilities, please contact us for more information.

De Montfort Street
Leicester LE1 7GR
England

t. 0116 254 4773

f. 0116 247 0804

e. events@belmonthotel.co.uk

w. www.belmonthotel.co.uk